

LEGEND

123

TREES TO BE REMOVED

123

TREES TO BE RETAINED

---

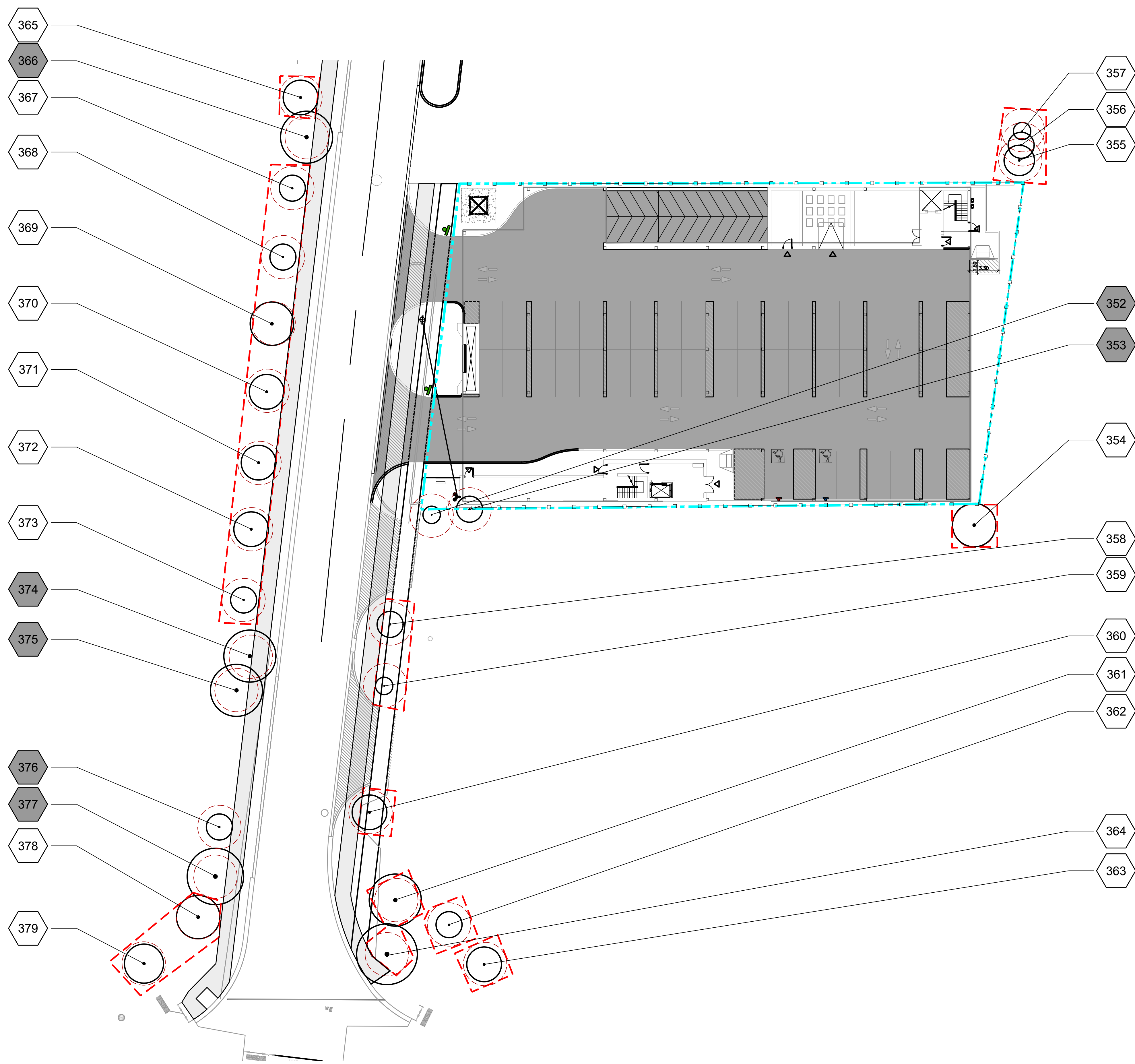
TREE PROTECTION FENCETREE PROTECTION ZONE

357

356

355

352

353

354

358

359

360

361

362

364

363

365

366

367

368

369

370

371

372

373

374

375

376

377

378

379

LOCATION MAP

GENERAL NOTES

THE LOCATION OF PROPERTY LINES, ELEVATIONS AND FACILITIES ON THIS PLAN WERE DRAWN ON THE BASIS OF A DIGITAL SITE PLAN OR SURVEY DATA PROVIDED BY OTHER CONSULTANTS.

IT IS THE RESPONSIBILITY OF THE CLIENT AND HIS CONTRACTORS TO CONFIRM THE ACCURACY OF THE SETBACKS, LOCATIONS AND GRADES ETC. ANY VARIATIONS BETWEEN EXISTING CONDITIONS AND THIS PLAN SHOULD BE ADJUSTED ON SITE AND REPORTED TO THE CONSULTING LANDSCAPE ARCHITECT TO DETERMINE THE IMPACT OF THE VARIATIONS ON THE SUITABILITY OF THE PROPOSED DEVELOPMENT.

CONSTRUCTION MUST CONFORM TO ALL CODES AND REQUIREMENTS OF AUTHORITIES HAVING JURISDICTION.

REVISIONS

NO.	DATE	NOTES	BY
2	2025-03-04	LANDSCAPE PLAN	TN
1	2025-03-04	TREE PRESERVATION PLAN	TN

THESE LANDSCAPE DRAWINGS SHALL ONLY BE USED FOR THE PURPOSES INDICATED BELOW AS NOTED AND WHEN SIGNED BY THE CONSULTING LANDSCAPE ARCHITECT.

CONCEPTUAL

TENDER

PRELIMINARY

CONTRACT

SITE PLAN

CONSTRUCTION

PERMIT

AS-BUILT

ASSOCIATION OF LANDSCAPE ARCHITECTS  
KYLE FOOTE  
MEMBER  
ONLINE

HKLA

LANDSCAPE ARCHITECTS & CONSULTING ARBORISTS

230 Westney Road S Unit 308, Ajax, ON L1S 7J5  
O: (905) 838-5566 | E: info@hkl.ca | W: www.hkl.ca

THESE DRAWINGS ARE INSTRUMENTS OF SERVICE AND THE LANDSCAPE ARCHITECT RETAINS OWNERSHIP OF THESE DRAWINGS. THEY ARE FOR SITE PLAN APPROVAL ONLY AND MAY REQUIRE FURTHER CONSTRUCTION DETAILING AND COORDINATION WITH OTHER ASSOCIATED PROFESSIONAL DESIGN SERVICES BEFORE ACTUAL TENDER AND CONSTRUCTION COMMENCES. DIMENSIONS ARE TO BE VERIFIED PRIOR TO CONSTRUCTION. DRAWINGS ARE NOT TO BE SCALED. IT IS ADVISED THAT CONTRACTORS CONTACT THE LANDSCAPE ARCHITECT PRIOR TO CONSTRUCTION TO ENSURE THE USE OF THE LATEST REVISED DRAWINGS. THE LANDSCAPE ARCHITECT IS NOT LIABLE FOR ERRORS OR OMISSIONS ARISING FROM UTILIZATION OF THESE PLANS BEFORE THE SAID DRAWINGS ARE SEALED, SIGNED AND DATED, AND THE LANDSCAPE ARCHITECT IS CONTRACTED TO PROVIDE CONSTRUCTION ADMINISTRATION AND CERTIFICATION SERVICES BY THE OWNER. ALL APPARENT DISCREPANCIES ARE TO BE REPORTED IN WRITING TO THE LANDSCAPE ARCHITECT BEFORE CONSTRUCTION COMMENCES.

PROJECT:  
MOSQUE - 27 WINONA DR.  
STOUFFVILLE

DRAWING:  
TREE PRESERVATION PLAN

DRAWN BY:  
TN

CHECKED BY:  
KF

JOB NO.:  
2025-008

SCALE:  
1:250

DATE:  
2025-02-25

DRAWING  
1 of 4

L-TP1

File #2025-008



Tree Inventory  
Project: Place of Worship - 27  
Winona

HKA Job #: 2025-008

Date: 2025-02-24  
Conditions: -10

Inventory Done By: Ross  
Williams

CODES		
DBH	Diameter at breast height	(mm)
SPR	Spread	(m)
HT	Height	(m)
TI	Trunk Integrity	(G,F,P)
CS	Crown Structure	(G,F,P)
CV	Crown Vigor	(G,F,P)
CDB	Crown Die Black	(%)
SPP	Species Potential	(L,M,H)
SIP	Site Potential	(L,M,H)
PHY	Physical Condition	(text)
~ = Estimate (L)=low (M)=moderate (H)=high (G) = Good, (F) = Fair, (P) = Poor		

Tree Tag #	Common Name	Scientific Name	DBH	SP	HT	TI	CS	CV	CDB	SPP	SIP	TPZ	PHY	Notes	Recommendation (REMOVE/RETAIN)
352	White Oak	Quercus alba	20	2	5	G	G	G	15%	H	L		Within constuction zone on property		REMOVE
353	White Oak	Quercus alba	33	3	3	P	P	P	100%	H	L		Within constuction zone on property	Standing snag	REMOVE
354	White Oak	Quercus alba	21	5	7	G	G	G	15%	H	H	2.5	Neighbouring Property	Grown into garbage enclosure on neighbouring property	RETAIN
355	Blue Spruce	Picea pungens	18	3.5	6	G	G	G	15%	H	H	2.5	Off property within 10m of site boundary		RETAIN
356	Blue Spruce	Picea pungens	15	3	6	G	G	G	15%	H	H	2.5	Off property within 10m of site boundary		RETAIN
357	Blue Spruce	Picea pungens	13	2	5	G	G	G	15%	H	H	2.5	Off property within 10m of site boundary		RETAIN
358	Sugar Maple	Acer saccharum	21	3	5	G	G	G	15%	H	H	2.5	Boulevard tree on neighbouring property - within 6m of proposed sidewalk.		RETAIN WITH INURY
359	Sugar Maple	Acer saccharum	18	2	5.5	G	G	G	15%	H	H	2.5	Boulevard tree on neighbouring property - within 6m of proposed sidewalk.		RETAIN WITH INURY
360	Sugar Maple	Acer saccharum	18	4	6	G	G	G	15%	H	H	2.5	Boulevard tree on neighbouring property - within 6m of proposed sidewalk.		RETAIN WITH INURY
361	Sugar Maple	Acer saccharum	30	6	8	G	G	G	15%	H	H	2.5	Boulevard tree on neighbouring property - within 6m of proposed sidewalk.		RETAIN
362	Sugar Maple	Acer saccharum	24	3	7	G	G	G	15%	H	H	2.5	Boulevard tree on neighbouring property - within 6m of proposed sidewalk.		RETAIN
363	Sugar Maple	Acer saccharum	26	4	5	G	G	G	15%	H	H	2.5	Boulevard tree on neighbouring property - within 6m of proposed sidewalk.		RETAIN
364	Honey Locust	Gleditsia triacanthos	37	7	8	G	G	G	15%	M	H	2.5	Boulevard tree on neighbouring property - within 6m of proposed sidewalk.		RETAIN WITH INURY
365	Honey Locust	Gleditsia triacanthos	15	4	4	G	G	G	15%	M	H	2.5	Boulevard tree on neighbouring property - within 6m of proposed sidewalk.		RETAIN WITH INURY
366	Honey Locust	Gleditsia triacanthos	27	6	6	G	G	G	15%	M	H	2.5	Boulevard tree on neighbouring property - within 6m of proposed sidewalk.		REMOVE
367	Red Maple	Acer rubrum	17	3	6	G	G	G	15%	H	H	2.5	Boulevard tree on neighbouring property - within 6m of proposed sidewalk.		RETAIN WITH INURY
368	Red Maple	Acer rubrum	17	3	4	G	G	G	15%	H	H	2.5	Boulevard tree on neighbouring property - within 6m of proposed sidewalk.		RETAIN WITH INURY
369	Red Maple	Acer rubrum	25	5	6	G	G	G	15%	H	H	2.5	Boulevard tree on neighbouring property - within 6m of proposed sidewalk.		RETAIN WITH INURY
370	Red Maple	Acer rubrum	23	4	6	G	G	G	15%	H	H	2.5	Boulevard tree on neighbouring property - within 6m of proposed sidewalk.		RETAIN WITH INURY
371	Red Maple	Acer rubrum	19	4	6	G	G	G	15%	H	H	2.5	Boulevard tree on neighbouring property - within 6m of proposed sidewalk.		RETAIN WITH INURY
372	Red Maple	Acer rubrum	22	4	6	G	G	G	15%	H	H	2.5	Boulevard tree on neighbouring property - within 6m of proposed sidewalk.		RETAIN WITH INURY
373	Red Maple	Acer rubrum	15	3	6	G	G	G	15%	M	H	2.5	Boulevard tree on neighbouring property - within 6m of proposed sidewalk.		RETAIN WITH INURY
374	Honey Locust	Gleditsia triacanthos	25	6	5	G	G	G	15%	M	H	2.5	Boulevard tree on neighbouring property - within 6m of proposed sidewalk.		REMOVE
375	Honey Locust	Gleditsia triacanthos	28	6	6	G	G	G	15%	M	H	2.5	Boulevard tree on neighbouring property - within 6m of proposed sidewalk.		REMOVE
376	Honey Locust	Gleditsia triacanthos	24	3	5	G	G	G	15%	M	H	2.5	Boulevard tree on neighbouring property - within 6m of proposed sidewalk.		REMOVE
377	Honey Locust	Gleditsia triacanthos	27	6.5	8	G	G	G	15%	M	H	2.5	Boulevard tree on neighbouring property - within 6m of proposed sidewalk.		REMOVE
378	Honey Locust	Gleditsia triacanthos	26	5	8	G	G	G	15%	M	H	2.5	Boulevard tree on neighbouring property - within 6m of proposed sidewalk.		RETAIN
379	Honey Locust	Gleditsia triacanthos	28	4.5	7.5	G	G	G	15%	M	H	2.5	Boulevard tree on neighbouring property - within 6m of proposed sidewalk.		RETAIN

NOTE:  
IN ACCORDANCE TO STOUFFVILLE, TREE PROTECTION TREES BETWEEN 30CM - 40 CM ARE REQUIRED TO HAVE A MINIMUM OF 2.5 METER RADIUS.

LOCATION MAP

GENERAL NOTES

THE LOCATION OF PROPERTY LINES, ELEVATIONS AND FACILITIES ON THIS PLAN WERE DRAWN ON THE BASIS OF A DIGITAL SITE PLAN OR SURVEY DATA PROVIDED BY OTHER CONSULTANTS.

IT IS THE RESPONSIBILITY OF THE CLIENT AND HIS CONTRACTORS TO CONFIRM THE ACCURACY OF THE SETBACKS, LOCATIONS AND GRADES ETC. ANY VARIATIONS BETWEEN EXISTING CONDITIONS AND THIS PLAN SHOULD BE ADJUSTED ON SITE AND REPORTED TO THE CONSULTING LANDSCAPE ARCHITECT TO DETERMINE THE IMPACT OF THE VARIATIONS ON THE SUITABILITY OF THE PROPOSED DEVELOPMENT.

CONSTRUCTION MUST CONFORM TO ALL CODES AND REQUIREMENTS OF AUTHORITIES HAVING JURISDICTION.

REVISIONS

2	2025-03-04	LANDSCAPE PLAN	TN
1	2025-03-04	TREE PRESERVATION PLAN	TN
NO.	DATE	NOTES	BY

THESE LANDSCAPE DRAWINGS SHALL ONLY BE USED FOR THE PURPOSES INDICATED BELOW AS NOTED AND WHEN SIGNED BY THE CONSULTING LANDSCAPE ARCHITECT.

<input checked="" type="checkbox"/>	CONCEPTUAL	<input type="checkbox"/>	TENDER
<input type="checkbox"/>	PRELIMINARY	<input type="checkbox"/>	CONTRACT
<input type="checkbox"/>	SITE PLAN	<input type="checkbox"/>	CONSTRUCTION
<input type="checkbox"/>	PERMIT	<input type="checkbox"/>	AS-BUILT

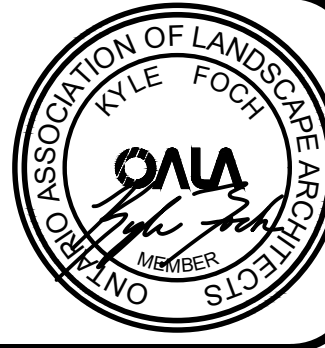

THESE DRAWINGS ARE INSTRUMENTS OF SERVICE AND THE LANDSCAPE ARCHITECT RETAINS OWNERSHIP OF THESE DRAWINGS. THEY ARE FOR SITE PLAN APPROVAL ONLY AND MAY REQUIRE FURTHER CONSTRUCTION DETAILING AND COORDINATION WITH OTHER ASSOCIATED PROFESSIONAL DESIGN SERVICES BEFORE ACTUAL TENDER AND CONSTRUCTION COMMENCES. DIMENSIONS ARE TO BE VERIFIED PRIOR TO CONSTRUCTION. DRAWINGS ARE NOT TO BE SCALED. IT IS ADVISED THAT CONTRACTORS CONTACT THE LANDSCAPE ARCHITECT PRIOR TO CONSTRUCTION TO ENSURE THE USE OF THE LATEST REVISED DRAWINGS. THE LANDSCAPE ARCHITECT IS NOT LIABLE FOR ERRORS OR OMISSIONS ARISING FROM UTILIZATION OF THESE PLANS BEFORE THE SAID DRAWINGS ARE SEALED, SIGNED AND DATED. AND THE LANDSCAPE ARCHITECT IS CONTRACTED TO PROVIDE CONSTRUCTION ADMINISTRATION AND CERTIFICATION SERVICES BY THE OWNER. ALL APPARENT DISCREPANCIES ARE TO BE REPORTED IN WRITING TO THE LANDSCAPE ARCHITECT BEFORE CONSTRUCTION COMMENCES.

PROJECT:  
MOSQUE - 27 WINONA DR.  
STOUFFVILLE

DRAWING: TREE PRESERVATION	
DRAWN BY: TN	SCALE:
CHECKED BY: KF	DATE: 2025-02-25
JOB NO.: 2025-008	DRAWING 1 of 4

L-TP2

File #2025-008



REFERENCE NOTES SCHEDULE

SYMBOL	DESCRIPTION	QTY	DETAIL
	Site Signage - Stop Sign	2	
32 EXTERIOR IMPROVEMENTS			
	Heavy Duty Asphalt	1,804 m²	
	Concrete Paving	429.9 m²	4/L-D1
	Patterned Concrete - PCRT 1400 ORIGIN SERIES	71.0 m²	
Fences and Gates			
	1.5 Steel Fence	166.7 m	
Identification Devices			
	Van Accessible Parking Sign	1	
	Accessible Parking Sign	1	
Turf & Grasses			
	Sod over 150mm Topsoil	214.1 m²	3/L-D1

PLANT SCHEDULE

CODE	QTY	BOTANICAL NAME	COMMON NAME	SIZE	CONT	REMARKS
TREES						
AA	3	Amelanchier alnifolia 'Obelisk'	Standing Ovation™ Serviceberry	60mm Cal.		
AC	2	Amelanchier canadensis	Serviceberry	150cm Ht. Multistem	W.B.	
SHRUBS						
PO	10	Physocarpus opulifolius	Ninebark	60cm Ht. Potted	Potted	
TM	5	Taxus x media 'Hicksii'	Hicks Anglo-Japanese Yew	60cm Ht. Potted		

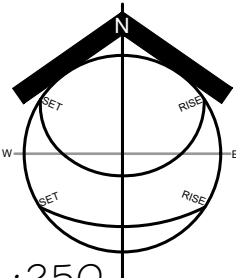
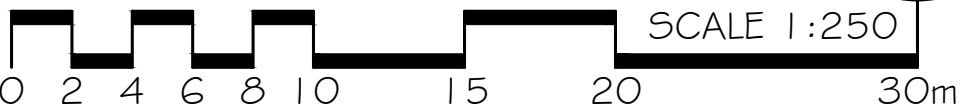
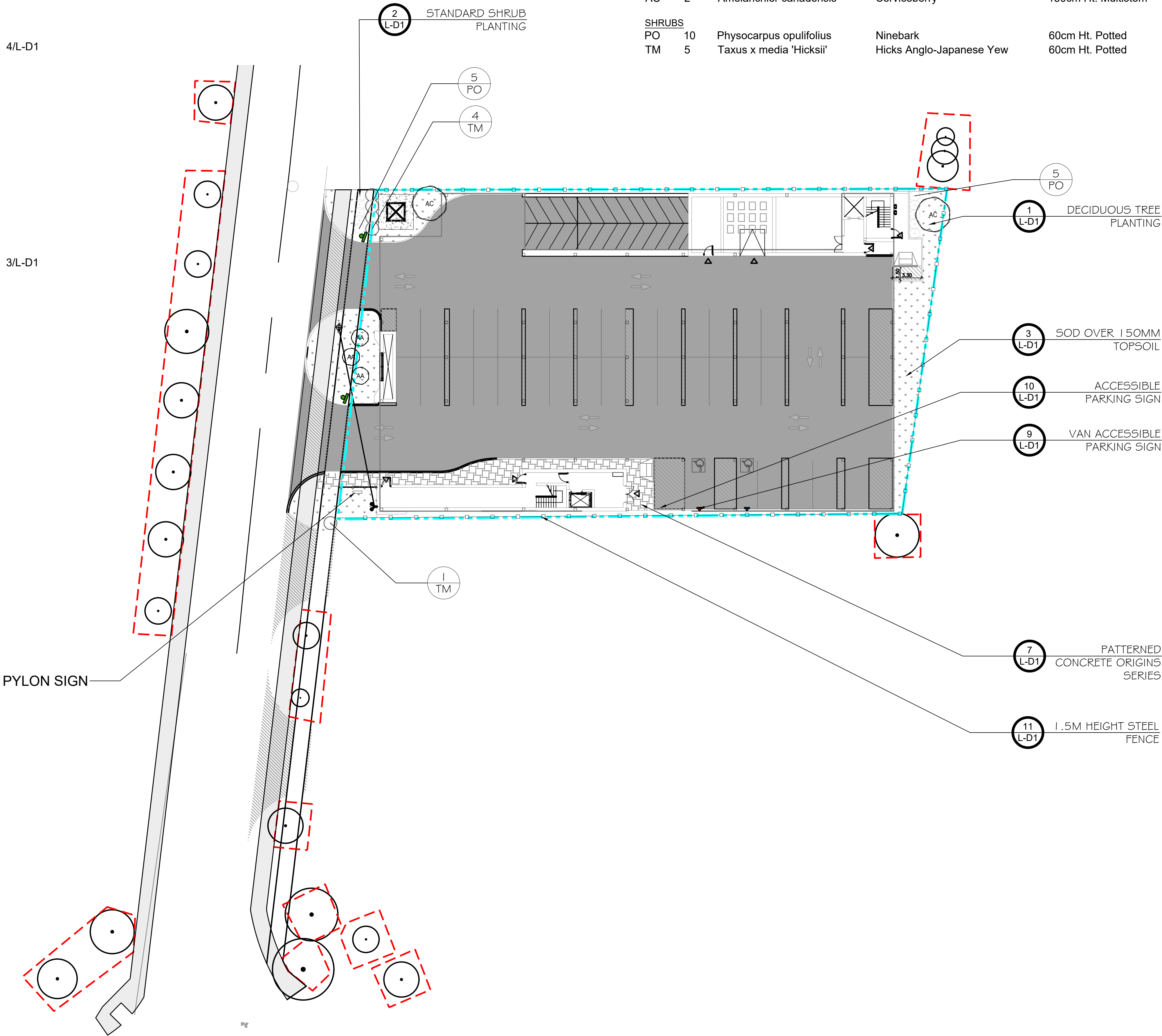

LOCATION MAP

GENERAL NOTES

THE LOCATION OF PROPERTY LINES, ELEVATIONS AND FACILITIES ON THIS PLAN WERE DRAWN ON THE BASIS OF A DIGITAL SITE PLAN OR SURVEY DATA PROVIDED BY OTHER CONSULTANTS.









IT IS THE RESPONSIBILITY OF THE CLIENT AND HIS CONTRACTORS TO CONFIRM THE ACCURACY OF THE SETBACKS, LOCATIONS AND GRADES ETC. ANY VARIATIONS BETWEEN EXISTING CONDITIONS AND THIS PLAN SHOULD BE ADJUSTED ON SITE AND REPORTED TO THE CONSULTING LANDSCAPE ARCHITECT TO DETERMINE THE IMPACT OF THE VARIATIONS ON THE SUITABILITY OF THE PROPOSED DEVELOPMENT.

CONSTRUCTION MUST CONFORM TO ALL CODES AND REQUIREMENTS OF AUTHORITIES HAVING JURISDICTION.

REVISIONS

NO.	DATE	NOTES	BY
2	2025-03-04	LANDSCAPE PLAN	TN
1	2025-03-04	TREE PRESERVATION PLAN	TN

THESE LANDSCAPE DRAWINGS SHALL ONLY BE USED FOR THE PURPOSES INDICATED BELOW AS NOTED AND WHEN SIGNED BY THE CONSULTING LANDSCAPE ARCHITECT.

	CONCEPTUAL		TENDER
	PRELIMINARY		CONTRACT
	SITE PLAN		CONSTRUCTION
	PERMIT		AS-BUILT

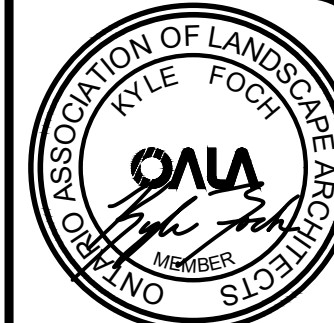

THESE DRAWINGS ARE INSTRUMENTS OF SERVICE AND THE LANDSCAPE ARCHITECT RETAINS OWNERSHIP OF THESE DRAWINGS. THEY ARE FOR SITE PLAN APPROVAL ONLY AND MAY REQUIRE FURTHER CONSTRUCTION DETAILING AND COORDINATION WITH OTHER ASSOCIATED PROFESSIONAL DESIGN SERVICES BEFORE ACTUAL TENDER AND CONSTRUCTION COMMENCES. DIMENSIONS ARE TO BE VERIFIED PRIOR TO CONSTRUCTION. DRAWINGS ARE NOT TO BE SCALED. IT IS ADVISED THAT CONTRACTORS CONTACT THE LANDSCAPE ARCHITECT PRIOR TO CONSTRUCTION TO ENSURE THE USE OF THE LATEST REVISED DRAWINGS. THE LANDSCAPE ARCHITECT IS NOT LIABLE FOR ERRORS OR OMISSIONS ARISING FROM UTILIZATION OF THESE PLANS BEFORE THE SAID DRAWINGS ARE SEALED, SIGNED AND DATED, AND THE LANDSCAPE ARCHITECT IS CONTRACTED TO PROVIDE CONSTRUCTION ADMINISTRATION AND CERTIFICATION SERVICES BY THE OWNER. ALL APPARENT DISCREPANCIES ARE TO BE REPORTED IN WRITING TO THE LANDSCAPE ARCHITECT BEFORE CONSTRUCTION COMMENCES.

PROJECT: MOSQUE - 27 WINONA DR. STOUFFVILLE

DRAWING: LANDSCAPE DRAWING

DRAWN BY: TN	SCALE: 1:250	L-L1 DRAWING 3 of 4
CHECKED BY: KF	DATE: 2025-02-25	
JOB NO.: 2025-008		

File #2025-008



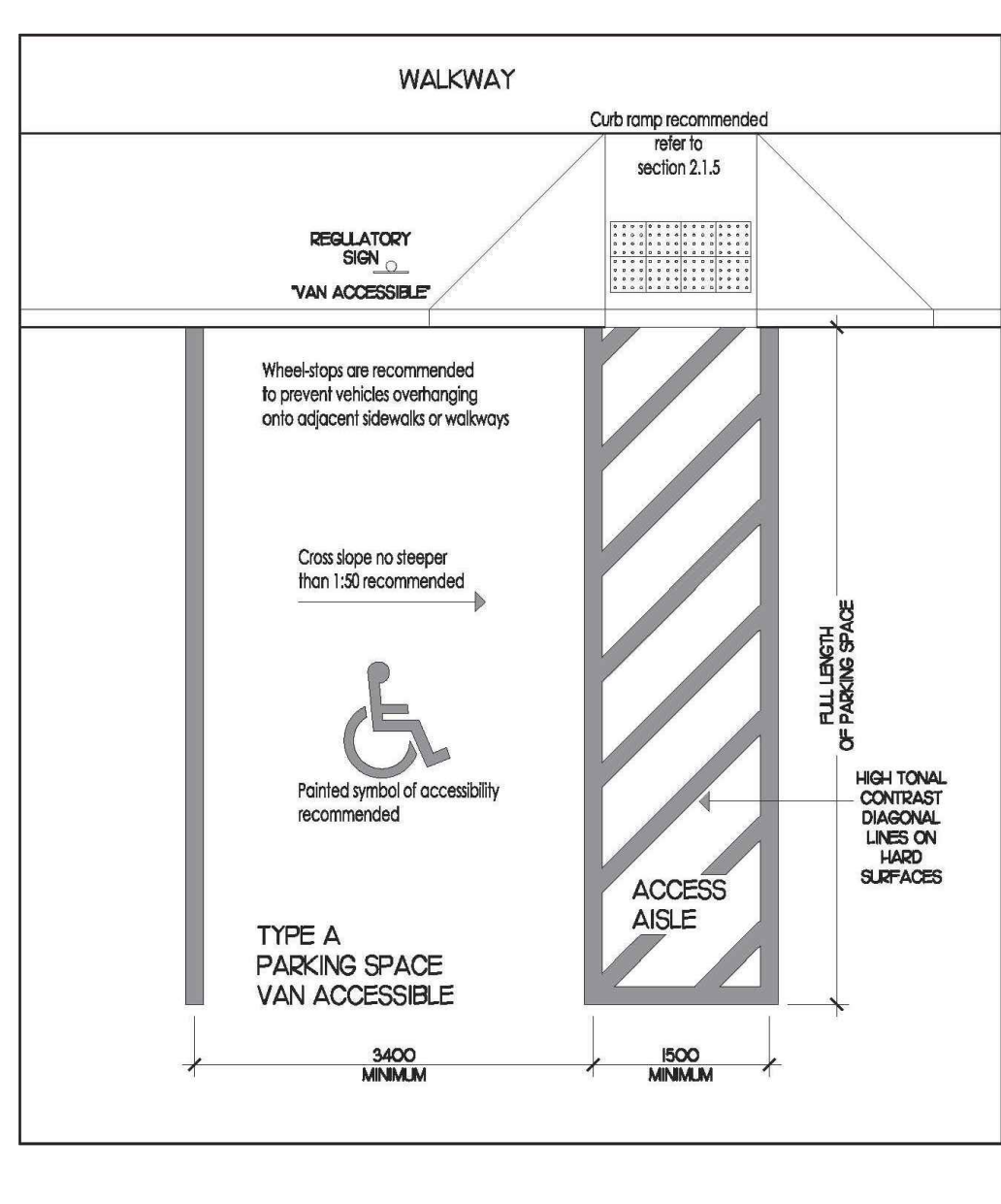
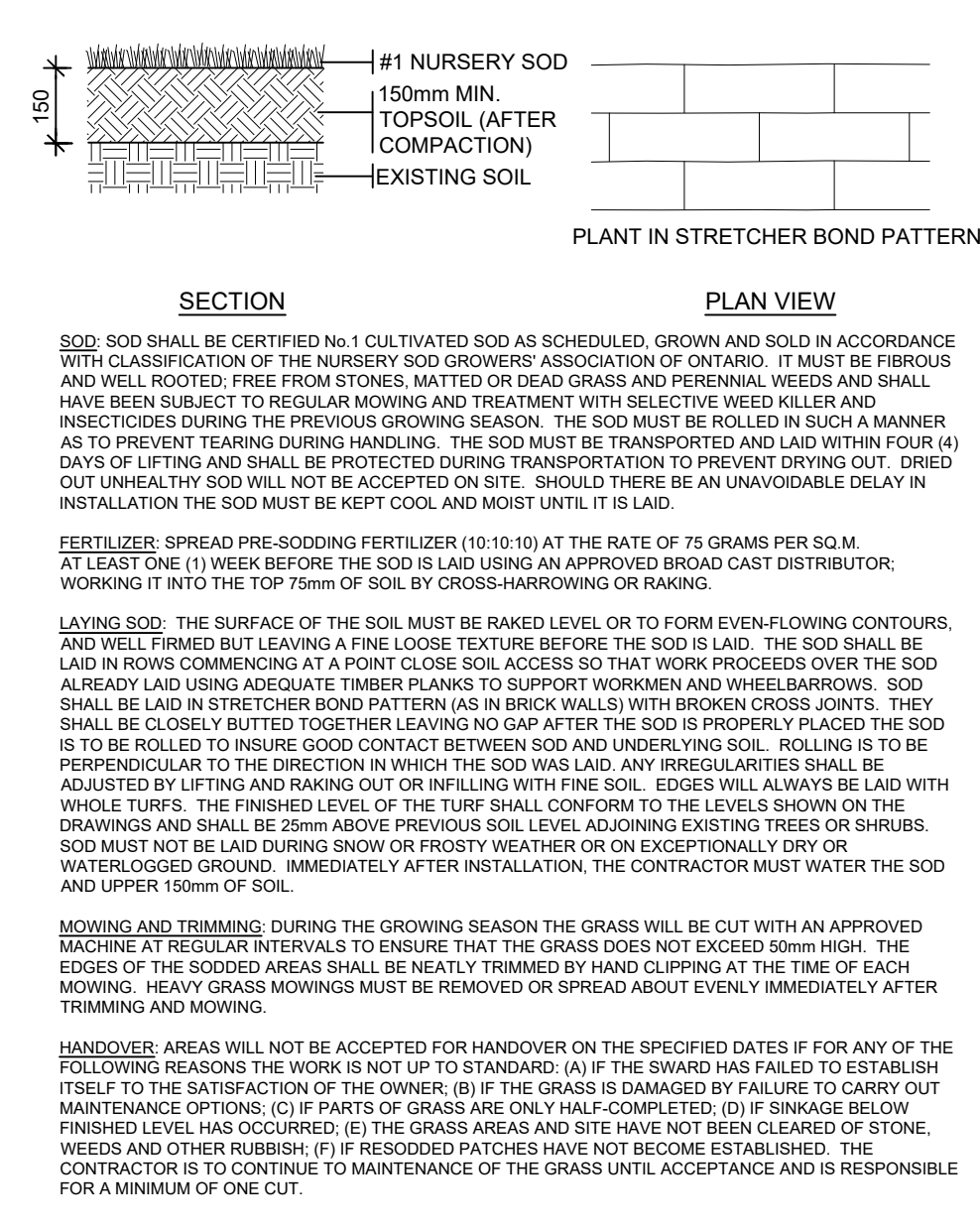

**5 VAN ACCESSIBLE PARKING STALL**  
N.T.S. TYPE A - VAN ACCESSIBLE 324102-04

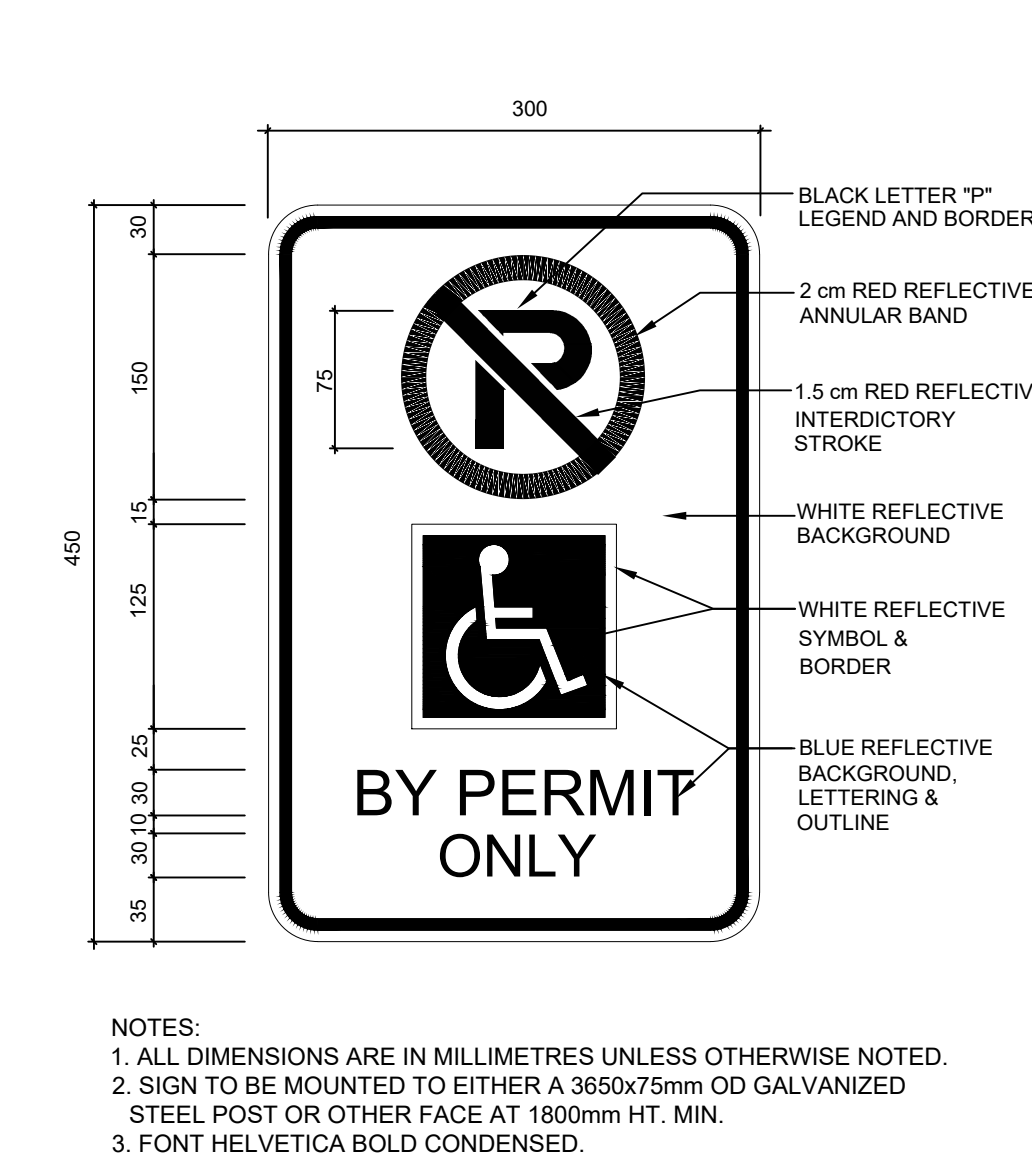
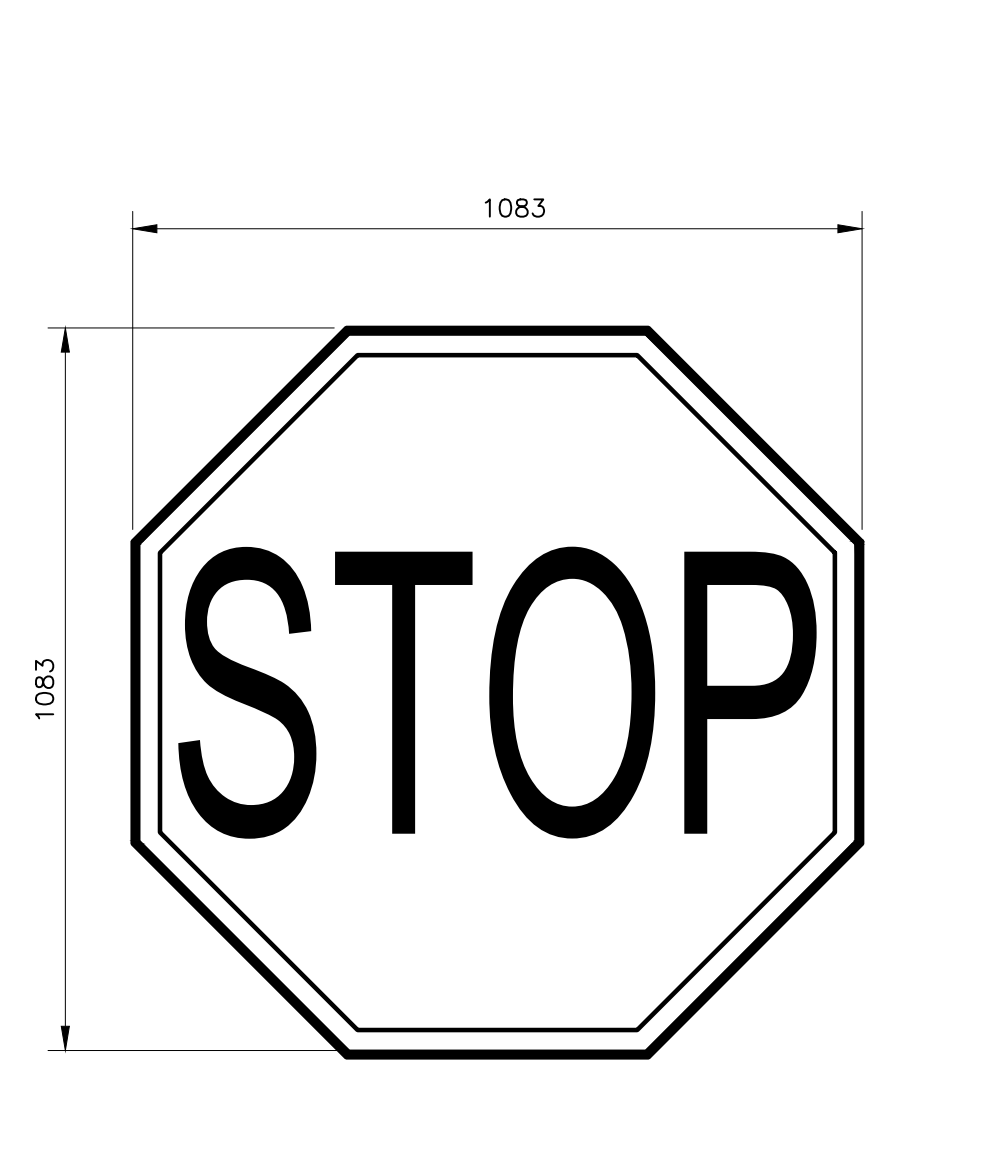

**10 ACCESSIBLE PARKING SIGN**

---

N.T.S. 324123.03-22

PROJECT:	
<h1 style="margin: 0;">MOSQUE - 27 WINONA DR.</h1> <h2 style="margin: 0;">STOUFFVILLE</h2>	
DRAWING:	
<h3 style="margin: 0;">DETAIL SHEET</h3>	

DRAWN BY: <div style="text-align: center; font-weight: bold; font-size: 1.2em;">TN</div>	SCALE: <div style="text-align: center; font-weight: bold; font-size: 1.2em;">1" = 10'</div>	<div style="font-size: 4em; font-weight: bold; margin: 0;">L-D1</div> <div style="margin-top: 10px;">             DRAWING              4 of 4           </div>
CHECKED BY: <div style="text-align: center; font-weight: bold; font-size: 1.2em;">KF</div>	DATE: <div style="text-align: center; font-weight: bold; font-size: 1.2em;">2025-02-25</div>	
JOB NO.: <div style="text-align: center; font-weight: bold; font-size: 1.5em;">2025-008</div>		

File #2025-008

DRAWING:		DETAIL SHEET	
DRAWN BY: TN	SCALE:	<div style="font-size: 48pt; font-weight: bold;">L-D1</div> <div style="text-align: center;">DRAWING 4 of 4</div>	
CHECKED BY: KF	DATE: 2025-02-25		
JOB NO.: 2025-008			
File #2025-008			